











Switching Plug 230VAC / 12A CSAP-01/xx-12E





868.3 MHz



IP20

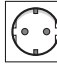
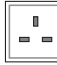

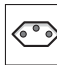
**Multi-functional
Button**

**EMS
Multi-color LED**

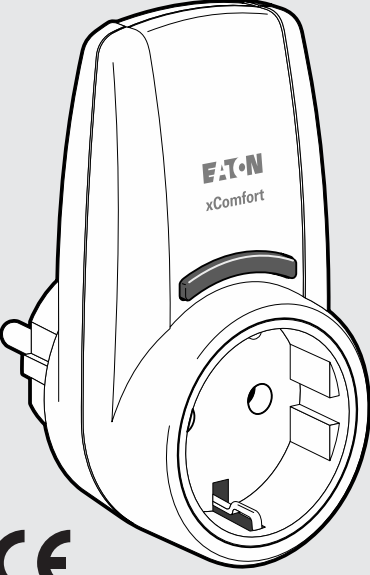
Plug types

 F-Type Schuko CSAP-01/Fx-12E	 G-Type (British Standard) CSAP-01/Gx-12E
 E-Type (Earthing pin) CSAP-01/Ex-12E	 J-Type (S13) CSAP-01/Jx-12E





Technical Data / Technische gegevens / Tekniske data / Technische Daten / Technická data

Power supply	230 VAC +10% -15%, 50 Hz
Power standby	200mW (TYP)
Load	R,L,C,LED, 12A (at 40°C, Derating*)
Technology	Eaton Patented Hybrid Zero-cross
Switching lifetime	5x10 ⁷ (TYP)
Inrush current	500A@200us, 300A@1ms, 200A@3ms (TYP)
EMS	3W to 2760W, 5% (>3W)
RF	868,3MHz (xComfort compatible)
Button Operation	On / Off
Button LED	Multi-Color EMS power consumption
Dimensions	100.3 x 52 x 56.9 mm (H x W x D)

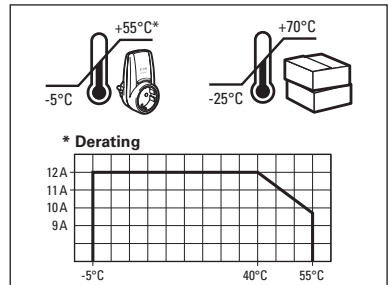

MRF	Version 2.60
RM	Version V41a
SHC-RF	Version 2.00
ECl-RF	Version 2.00
USB-RF	Version 2.00

Switching Plug

230VAC / 12A

Operation

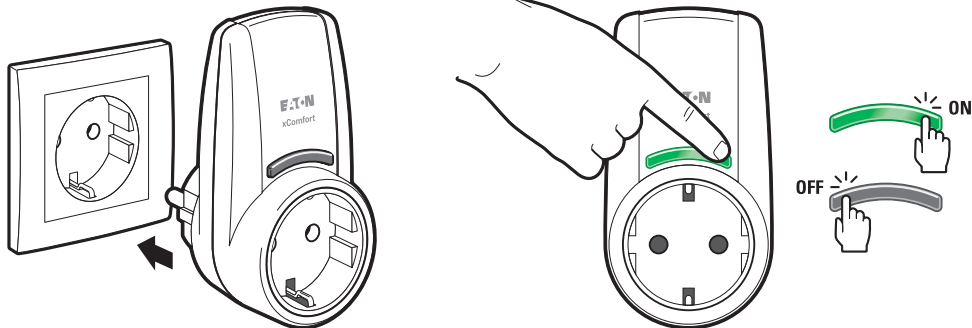

Programming

Button behaviour / Knopgedrag / Tastenfunktion / Knapp virkemåte / Funkce tlačítka

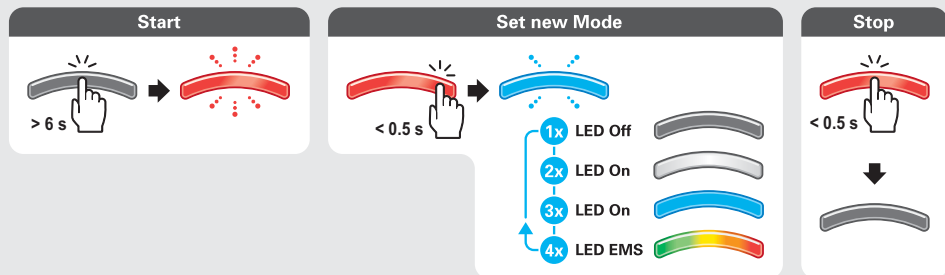

Assign Sensor in Basic Mode / Sensor in Basic Mode toewijzen / Tilknytte i Basic Mode / Zuweisen im Basic Mode / Přidat v základním režimu

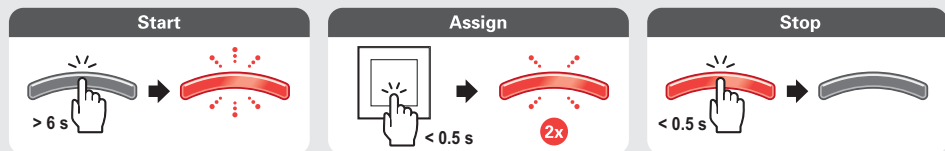

Remove Sensor in Basic Mode / Sensor in Basic Mode verwijderen / Fjerne i Basic Mode / Im Basic Mode löschen / Odstranit v základním režimu

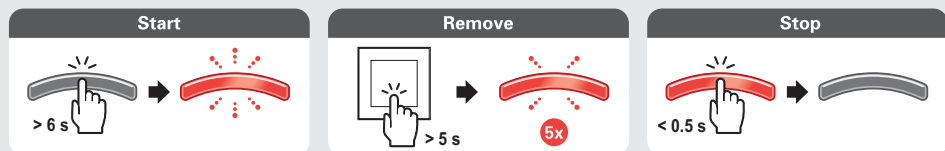

Button indication

LED Off Mode

(Off)



LED On Mode

(white)



LED On Mode

(blue)



LED EMS Mode

(multi-color)

% Power 2760W

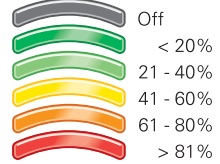

Actuator Off



Load error



Overload



Notification / Notificatie / Benachrichtigung / Melding / Zpráva

Start

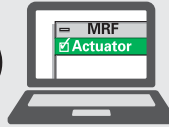
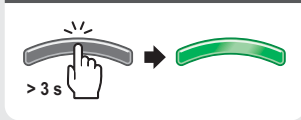

or Controller
of Controller
oder Controller
eller Controller
nebo řídicí jednotka

Back to factory default / Terug naar fabrieksinstellingen / Tilbake til fabrikkinnstillinger / Zurück zu den werkseitigen Standard / Zpět na tovární hodnoty

Start

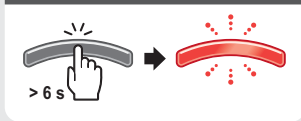

Reset

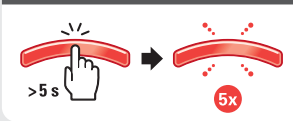



Declaration of Conformity

We, EATON Industries (Austria) GmbH
3943 Schrems, Eugenia 1
Austria

declare under our sole responsibility as the manufacturer that the product (family)

Eaton - Plug in adapter - switching, CSAP-01/xx-12E

(the declaration of conformity applies to all listed types within our actual product catalogue)

provided that it is installed, maintained and used in the application intended for, with respect to the relevant manufacturers instructions, installation standards and "good engineering practices"

complies with the provisions of Council directive(s):

RED Directive 2014/53/EU

RoHS Directive 2011/65/EU

based on compliance with following standard(s):

EN 301489-3 V2.1.1, EN 300220-2 V3.1.1, EN 50491-5-1:2010, EN 50491-5-2:2010, EN 62479:2010, IEC 60884-2-5:1995, EN 50428:2005 + A1:2007 + A2:2009, EN 50581:2012



EU- type examination performed by:
TÜV Austria Services GmbH, Notified Body
1230 Vienna, Deutschstrasse 10, Austria

Affixing date of CE mark: 2018
Doc.Id.: CSAP-01xx-12E_270718



Fernando Ceccarelli

Senior Vice President
General Manager

27.07.2018



Friedrich Schröder

Director Quality
& Systems